

Rock Hill Industrial Park

Industrial Building #1 5 Port Way



Description

Building Description:

- 3,000 square foot office & industrial space
- 60' x 68' parking area
- 2 - 12' Overhead Doors
- 12' x 10' enclosed storage space, 8' x 10' restroom with sink, and 24' x 20' mezzanine storage with railing/ capacity of 80 lbs. per sq. ft., and an 8' x 8' outdoor shed w/ 7' height
- Optional door to 4 Port Way
- Thermostat-controlled HVAC system
- Three-phase electrical power
- \$750.00 a month plus 12.84% leasehold tax making it a total of \$846.30 per month plus utilities

Utilities:

- Electricity provided by Pacific Power
- Garbage by BDI
- Water, sewer from the City of Dayton
- All utilities at tenant's expense

Zoning:

- Light Industrial / Fringe Commercial

Transportation:

- Cameron Street is adjacent to Highway 12, a two-lane state highway
- Nearest airport is in Walla Walla, 30 miles southwest

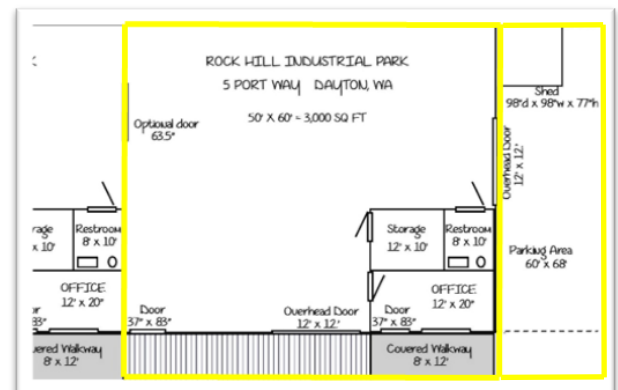

Contact the Port of Columbia for more details or to view this space,
tracy@portofcolumbia.org or 509-382-2577